

TOWN OF LIVERMORE
ELECTRICAL PERMIT APPLICATION

Permit # _____

Issue Date _____

Fee Amount _____

Approved by _____

PROPERTY OWNER _____

DATE _____ Owners Phone _____

LOCATION OF WORK _____

TAX MAP _____ LOT _____

TYPE OF WIRING BEING DONE (CHECK WHAT APPLIES)

COMMERCIAL _____

RESIDENTIAL _____

OUTLETS AND SWITCHES _____

SURFACE LIGHTS _____ RECESSED LIGHTS _____

SERVICE ENTRANCE UPGRADE _____

NEW SERVICE ENTRANCE _____

REMOTE PANEL _____

FEED ABOVE GROUND _____ BELOW GROUND _____

SMOKE DETECTORS _____

OTHER _____

Work being done by: Owner _____ Contractor _____

CONTRACTORS NAME _____

CONTRACTORS ADDRESS _____

MASTER LICENSE # _____ PHONE _____

**2014 NATIONAL ELECTRICAL CODE REQUIREMENTS FOR GFCI AND AFCI
SINGLE FAMILY DWELLING: ARTICLES 210.8 AND 210.12**

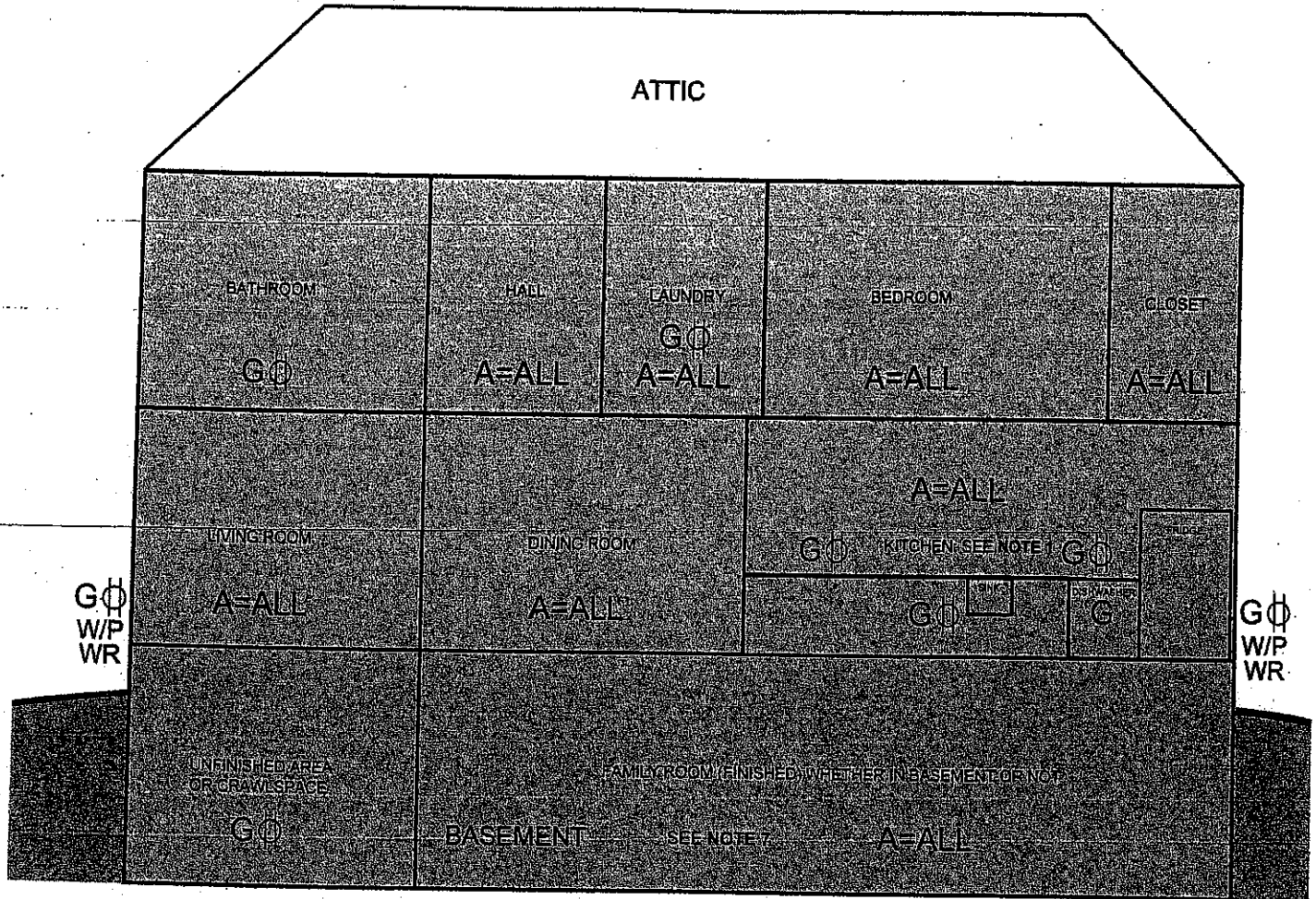

A=ALL AFCI: ALL 120V 15 AND 20 AMP CIRCUITS INCLUDING RECEPTACLES, LIGHTING OUTLETS SMOKE ALARM/FIRE ALARM CIRCUITS, ETC. THERE ARE SIX WAYS TO ACCOMPLISH THIS: SEE 210-12(A)(1-6). IN AREAS WHERE A=ALL IS PRESENT AND THERE IS ALSO A REQUIREMENT FOR GFCI, BOTH GFCI AND AFCI PROTECTION MUST BE INSTALLED

GFI ALL 120V 15 AND 20 AMP RECEPTACLES REQUIRED TO BE GFCI PROTECTED
G REQUIRED GFCI OUTLET (RECEPTACLE OR HARDWIRED)

NOTE 1: ALL 120V 15 AND 20 AMP KITCHEN COUNTER RECEPTACLES, ALL 120V 15 AND 20 AMP RECEPTACLES WITHIN 6' OF SINK AND THE DISHWASHER BRANCH CIRCUIT OUTLET MUST BE GFCI PROTECTED

NOTE 2: ALL 120V 15 AND 20 AMP RECEPTACLES WITHIN 6' OF ANY SINK, BATHTUB OR SHOWER STALL MUST BE GFCI PROTECTED: 210.8(A)(7) AND (9)

NOTE 3: OUTLETS IN SUNROOMS MUST BE AFCI PROTECTED: 210.12(A)

NOTE 4: GARAGES AND ACCESORY BUILDINGS MUST HAVE 120V 15 AND 20 AMP RECEPTACLES PROTECTED BY GFCI: 210.8(A)(2)

NOTE 5: ALL RECEPTACLES REQUIRED BY 210.52 MUST BE TAMPER-RESISTANT (EXCLUDES RECEPTACLES ABOVE 5.5', RECEPTACLES IN CLOSETS AND CRAWLSPACES)

W/P WR **NOTE 6:** ALL OUTSIDE (WET LOCATION) 15 OR 20 AMP RECEPTACLES MUST BE TYPE "WR" AND BE COVERED BY AN "EXTRA DUTY" COVER THAT IS WEATHERPROOF WHETHER OR NOT THE ATTACHMENT CAP IS INSERTED 408.9(B)(1)

NOTE 7: EXCEPTION EXISTS FOR RECEPTACLE SUPPLYING PERMANENTLY INSTALLED FIRE/BURGLAR ALARM SYSTEM IN BASEMENT 210.8(5) exc.

DEPARTMENT OF PROFESSIONAL & FINANCIAL REGULATION
OFFICE OF PROFESSIONAL & OCCUPATIONAL REGULATION

RAYMOND STANFORD
STATE ELECTRICAL INSPECTOR

MAILING ADDRESS:
35 STATE HOUSE STATION
AUGUSTA, ME 04333-0035
VOICE: (207) 624-8519
FAX: (207) 624-8636

PHYSICAL ADDRESS:
GARDINER ANNEX
76 NORTHERN AVENUE
GARDINER, MAINE 04345
TTY: MAINE RELAY 711
CELL PHONE: (207) 592-7908
WEB ADDRESS: www.maine.gov/professionallicensing
E-MAIL: raymond.stanford@maine.gov

